

# General Installation Instructions for Quaker Windows

Please read the following instructions thoroughly before beginning the installation process of the window. The instructions below are intended as a basic guide for window installation. If you require more in-depth instructions, please contact your Quaker window dealer.

## Installation of New Construction Vinyl Windows in Frame Walls

- Be sure your rough opening is level, plumb, and square, and the dimensions are correct (fig. 1). The width and height of your rough opening should be a minimum of 1/2" larger than your window size, but not to exceed 1".
- (fig. 2) Prepare the sill of your rough opening for flashing tape. Make sure that you use the correct flashing tape for your installation application. ‡ Cut a piece of tape (it must be a minimum of 12" longer than the rough opening width). Apply the flashing by centering it width-wise on the sill stud and adhering it to the rough opening. Flashing should touch the back edge of the sill stud but should not go onto the interior side of the stud. Flashing should cover the entire width of the sill stud and should extend at least 6" up each jamb. On the exterior side of the rough opening, the flashing should extend approximately 9" downward from the sill stud.
- When installing an operating unit (hung, slider, or venting), be sure that the operating sash is closed completely and locked.
- Apply a continuous bead of silicone caulk (3/8" wide) to the following places:
  - exterior face of the rough opening (fig. 4a)
  - backside of the nailing fin (fig. 4b)
- From the outside, center the window in the opening. Leave approximately 1/4" of room on each side.
- Find the pre-punched hole in the nailing fin's top right corner. Using roofing nails (minimum of 1" in length), nail the top right corner through the nailing fin (fig. 6).
- Shim and adjust so that the window is square and level, then nail the top left corner (fig. 7). Important Note: Thickness for all shims should be the same from the inside to the outside to ensure jambs will not bow or "hour-glass".
- Again, check the window to make sure it is square and level. If it is not, shim and adjust where needed until the window is level, plumb, and square. An even reveal around the window's frame should be seen.
- Nail the two remaining corners. Note: Units over 36" wide will require blocking under the window sill.
- Going around the perimeter of the nailing fin at 8" to 10" intervals, nail the pre-punched holes. DO NOT NAIL EACH HOLE. DO NOT NAIL TOO TIGHT.
- Check the window's operation. Window should work properly if installation is correct. Do not apply interior trim until window works properly.
- Vertically mulled units require a drip cap before the flashing is applied. Flash the nail fin along jambs. Then apply flashing to window header last (fig. 12). If properly applied, the flashing will eliminate water infiltration and assure a watertight seal.
- Place insulation strips (fiberglass or similar) between the window frame and rough opening to eliminate cold drafts. DO NOT OVER-PACK INSULATION. Also, do not use expanding or spray-in type foams. They will distort the window frame, causing operating and performance problems. Doing so will also void any warranty. Caulk around the entire interior perimeter of the window.
- Keep siding material 1/4" off the window head, so that pressure will not cause the window head to sag, and possibly damage glass and hinder the window's operation. ▲If working with masonry or brick applications, see steps below.

π For application instructions, see your authorized Quaker dealer, or call Quaker Window Products at 573-744-5211.  
 ‡ When using House Wraps and OSB substrates, or with applications under 45°F (7°C), spray an application adhesive (available at your Quaker dealer) around the perimeter of the window before applying flashing. Different applications require different spray adhesives so please check with your dealer for the proper type.

## ▲Installation of New Construction Windows into Masonry & Brick Veneer Walls

Follow same steps as shown above but also:

- Allow a 1/4" minimum clearance between the window frame perimeter and brick to allow for expansion and setting.
- Fill the void with silicone caulking.

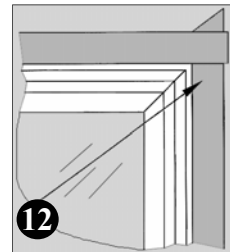
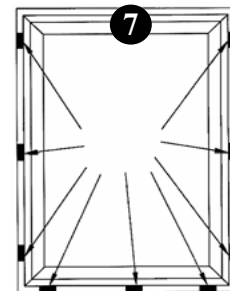
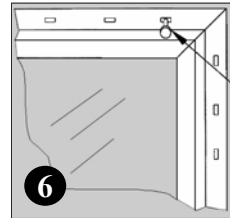
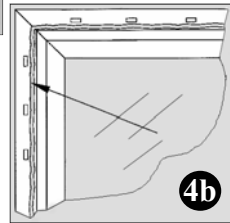
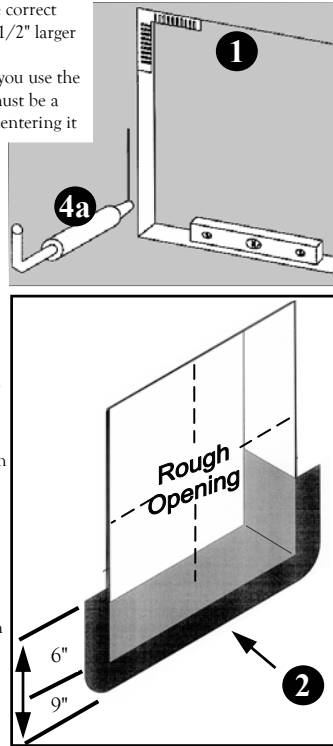

## WARNING (Failure to follow these instructions renders all warranties as null & void)

- Do not expose windows to direct heat or sunlight.
- Store all windows inside.
- When carrying window, always keep it in a vertical position.
- Stack windows as straight as possible to avoid bowing. Do not lay flat.
- Do not drill through window sill to install alarm wires.
- If using muriatic acid or brick wash cleaning solutions, please follow the manufacturer's instructions found on the product label or on the manufacturer's website.

**Special Note:** If broken, glass can fragment causing injury. All Quaker products are available with safety glass. In many areas, local building codes require safety glass in certain locations and/or applications. Unless Quaker's stipulations dictate safety glass or safety glass is specifically ordered, Quaker windows are not provided with safety glass. Before installing, Quaker recommends consulting local building codes for more definitive information.

## Installation of Replacement Vinyl Windows Preparation

- Remove inside trim stops on existing window opening.
- Remove existing lower sash by cutting sash cord or chain. Sash weights will fall.
- Remove lower sash & parting stops at sides and top.
- Remove upper sash in the same manner as lower sash.
- Remove the four pulley assemblies and plug holes with insulation.
- If installing exterior casing covers (i.e. coil stock, break metal), now is the time to put on the sill cover. Extend it far enough on the sill so the new window will come down on top of it.
- Caulk interior side of blindstop top and sides. Caulk inside edge of existing stool where window sill butts against stool.
- Caulk the head of the rough opening in two places, so that when the window is inserted into the opening, the window's head expander will press against it. Place a strip or two of insulation in the head expander before placing it on the new window.
- Place another strip of insulation on the sill. Set the window in the opening. Push out to stops.

## Installation

- Pack insulation around side jambs. Do not use expanding or spray-in type foams. They will distort the window frame, causing operating and performance problems. Doing so will also void any warranty.
- Lock up the window and check for squareness. Adjust as required. Sash MUST be square to master frame and bottom sash MUST sit evenly on sill. Shim window at jambs and wherever else accordingly. DO NOT OVERSHIM.
- Secure window in place using six installation screws through jambs. Bring screws up snug, but do not overtighten.
- Check for even alignment of both sashes to side jambs.
- Check to assure window is operating properly, then replace inside trim stops.
- Snap in the exterior sill trim. (It may need to be trimmed before it is applied.) Caulk and seal around it.
- Caulk around perimeter of window inside & outside.

Quaker Window Products reserves the right to implement design modifications &/or product changes at any time which may cause installation instructions to vary slightly.

10-06



A Tradition of Quality  
since 1949!





**QUAKER**<sup>®</sup>  
WINDOWS & DOORS

[www.quakerwindows.com](http://www.quakerwindows.com)