

3. WINDOW INSTALLATION AND FASTENING - CONTINUED

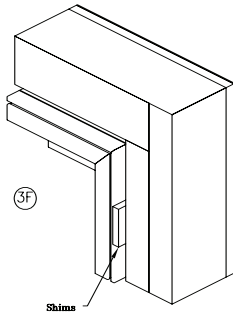
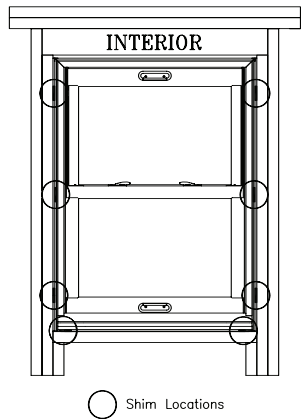

F. Place shims between the structural framing and the window framing in shown locations to prevent bowing. Shims must remain in place after installation. Use caution as to NOT OVER SHIM. This will cause deflection of the frame, which will hinder sash operation.

G. Check the width of the window frame to ensure consistent width at the top, middle and bottom of the unit. If the dimensions are not the same, re-shim accordingly. Again, re-check the window for level, plumb and square. Operate the sash and visually inspect all sight lines. Relock the sash and adjust if necessary to assure consistent sash reveal and ease of operation.

IMPACT UNITS

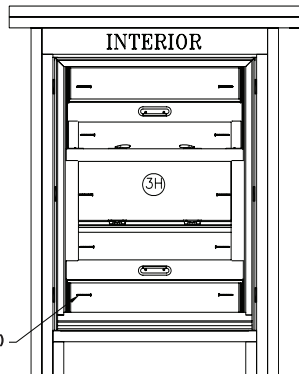

H. In addition to installing the window through the installation fin, attach the window through the jamb as shown.

Minimal Fastener Requirements

- Use #8 screws having at least 1 1/2" penetration into framing structure
- Install a total of 10 screws through the side jambs:
- 2 - 3" from head
 - 2 - 3" from sill
 - 2 - middle of side jambs
 - 2 - middle of upper sash
 - 2 - middle of lower sash

I. Insulate between the window and the framing with fiberglass insulation or equal. The space may be effectively filled with measured use of low expansion foam meant for window and door installations, but only after determining that the foam will not exert undo pressure against the frame, which can impair the operation. Distortion of the frame will affect the user's rights under the warranty.

J. Allow a 1/4" gap between the window frame and exterior cladding, siding, brick, stucco or stone on all sides (except vinyl J-channel). The gap (expansion joint) should be filled with the correct size closed cell backer rod on the sides and top only. AAMA approved exterior sealant shall be used to create proper sealant joint according to InstallationMasters™ guidelines which will require future maintenance.

BridgeWood™

NEW CONSTRUCTION INSTALLATION INSTRUCTIONS

Installation Instructions for BridgeWood Double Hung, Casement, Awning, Picture, Transom and Specialty Windows with a New Construction Installation Fin; including Modern, Traditional and Brickmould Casings.

(Please refer to appropriate installation instructions for units which are finless, come with an installation backer, and field mulled units.)

READ THESE INSTRUCTIONS COMPLETELY BEFORE BEGINNING. DO NOT PROCEED IF THESE INSTRUCTIONS ARE NOT FULLY UNDERSTOOD! Please inspect your MI Windows and Doors, Inc. product thoroughly before beginning installation. Do not install product if there is any observable defect. The product specification sheet and warranty include important information regarding your product and may include product - specific installation requirements (types of fasteners to be used with impact - resistant windows and limitations on the height at which the product may be installed): if you did not obtain copies, please contact MI Windows and Doors, Inc. Local building codes may impose additional requirements, and those codes supersede these instructions.

FAILURE TO FOLLOW THESE INSTRUCTIONS, AND BUILDING CODE REQUIREMENTS, MAY AFFECT THE REMEDIES AVAILABLE UNDER YOUR WARRANTY

1. ROUGH OPENING PREPARATION

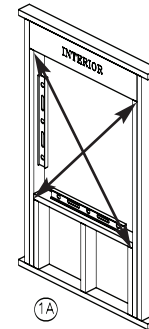

A. Verify that rough opening is 1/2" larger than the window frame, in both width and height. Make sure the rough opening is plumb, square and the sill plate is level. Check rough opening for squareness by measuring diagonally.

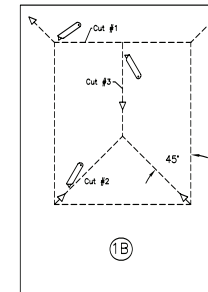

B. If the building has Weather Resistant Barrier (WRB), i.e.; House Wrap, prepare the opening according to the WRB manufacturer's instructions. At each top corner, make a 45° diagonal cut in the WRB. Fold up the WRB, so the top nail fin of the unit can be installed underneath it.

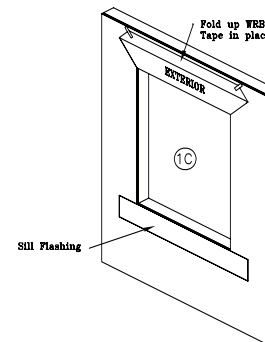

C. Flashing of the window opening is recommended and may be required by some building codes. Apply the sill flashing now. NOTE: Sill pans are optional unless required by code and should be installed level and sealed to the opening after applying the sill flashing.

2. WINDOW PREPARATION

A. Remove the cardboard packaging from the window. DO NOT remove shipping band that is attached to the double hung unit. This is to keep the unit from "bowing out" at the center point of the unit. Leave the sashes closed and locked throughout the installation process. Keep the side jambs plumb and square with the head and sill. Be careful not to "crown up" or "bow down" the sill or head. Constantly check the width, at the meeting rails of a double hung unit (center point of a casement) to avoid a "bowed out" installation.

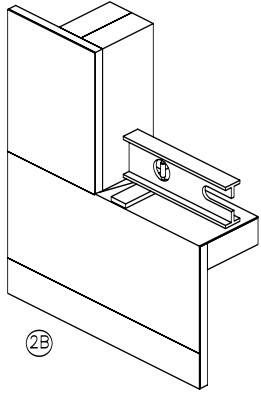

B. Place 1/4" flat shims on the rough opening sill plate, under the corners of the window (Do not place shims or blocks under the sill - except at the frame corners). Combination (mull) units require flat shims under each corner and at the vertical mull.

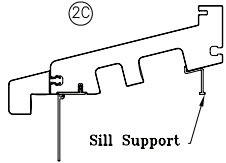

C. Units 3/0 and wider will have a center sill support. DO NOT REMOVE. Only shim under sill support, as necessary, to maintain a level sill condition. DO NOT OVER SHIM.

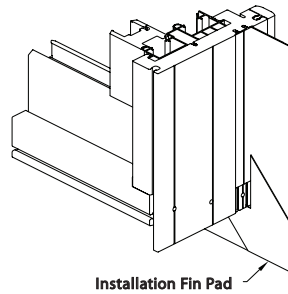
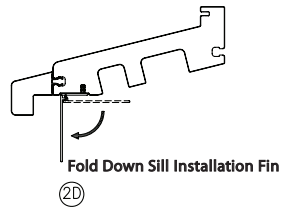

D. Fold down the bottom installation fin and apply the installation fin pads (included in the hardware pack) to the interior side of the fin, at each bottom corner, covering and sealing the entire joint at frame and across fin.

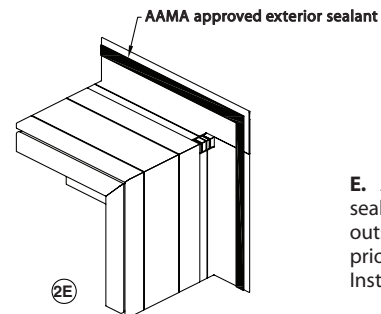

E. Apply a continuous 3/8" bead of AAMA approved exterior sealant to the interior (backside) of the installation fin, near the outside edge (in line with pre-punched holes) on ALL SIDES prior to setting the window into the rough opening. Refer to Installation Masters™ Guidelines for further details.

3. WINDOW INSTALLATION AND FASTENING

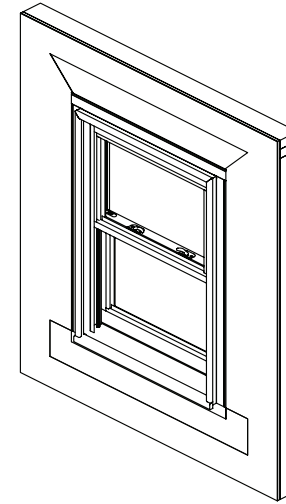
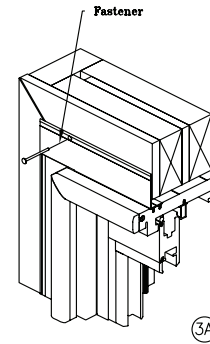

TWO OR MORE PEOPLE ARE REQUIRED TO PROPERLY INSTALL WINDOW

A. Set the window into the opening on the shims on the sill plate, tilt the top into position. Center the window in the opening (width) to allow for shimming. Place a temporary fastener through the slot provided in the installation fin towards top of one of the sides.

B. Check the squareness of the window by measuring the diagonal and check the "reveal" (space) between the bottom of the sash and the window sill. Relock the sash, adjust if necessary. Place an additional fastener diagonally opposite of the first fastener.

C. Continue to secure the window with fasteners that penetrate the framing by a minimum of 1". Install all fasteners straight, not on an angle. Prior to fastening the head and sill, be sure that they are straight and level. Fasteners should be applied in every slot of installation fin. Use appropriate fasteners as specified in the InstallationMaster™ Material Selection and Use Guide.

D. Apply AAMA approved exterior sealant over all fastener heads and outside edge of the installation fin, where it contacts the sheathing.

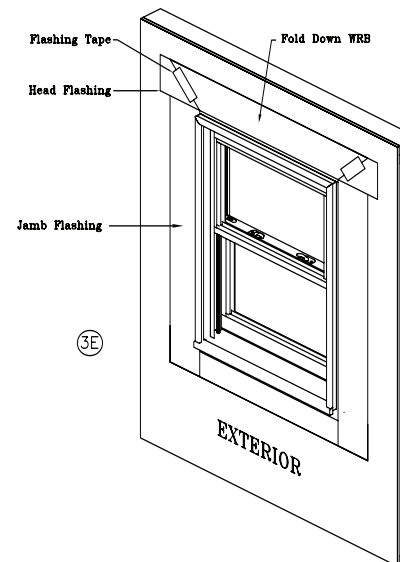

E. Apply side flashing over the installation fin and overlapping the sill flashing, extending beyond the top installation fin. Next, apply the top flashing, also covering the installation fin, overlapping and extending past the side flashing. Lastly, fold down the WRB flap, covering the top flashing. Tape the diagonal cuts above each top corner.